

**STUDIO TECNICO - ARCHITETTO - AGOSTINO GAMBINO**  
 VIA CAPRA 1/B - 37010 SAN ZENO DI MONTAGNA (VR) - TEL. 045 7285460 - CEL. 335 428845

**COMUNE DI : SAN ZENO DI MONTAGNA**  
**OGGETTO: PIANO ATTUATIVO RESIDENZIALE "PORA"**

TRV. **6** **DISEGNO: STRADE E PROFILI STRADALI**  
**PROPRIETARIO:** - CASTELLANI CIPRIANO -  
 - CASTELLANI PABLO  
**SCALA: 1:500 - 1:200** **REVISIONE IN DATA: 30/11/2023**

PROGETTISTA: DIR. LAVORI: IMPRESA: PROPRIETARIO:

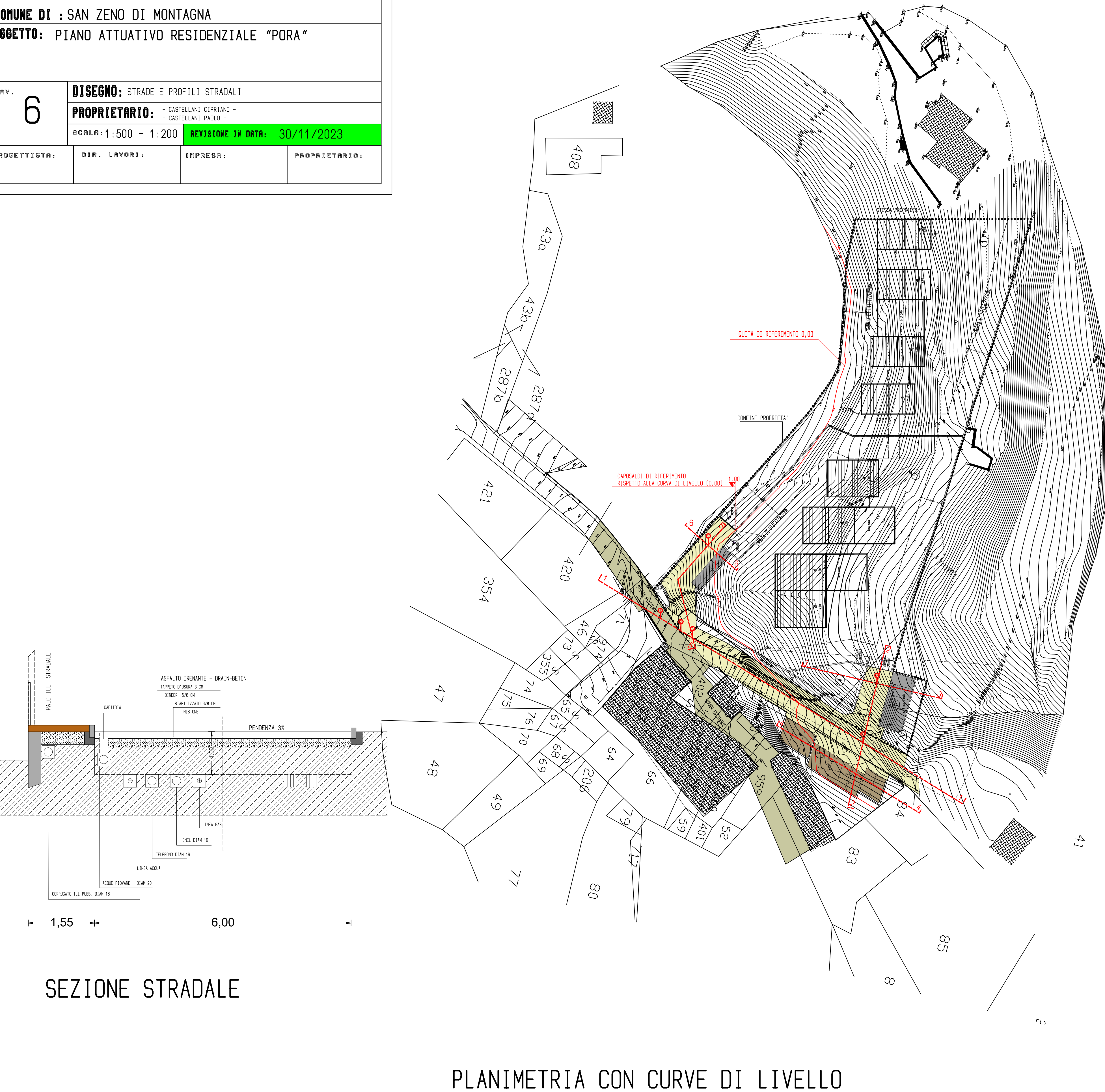

SEZIONE STRADALE

PLANIMETRIA CON CURVE DI LIVELLO

PLANIMETRIA STRADE

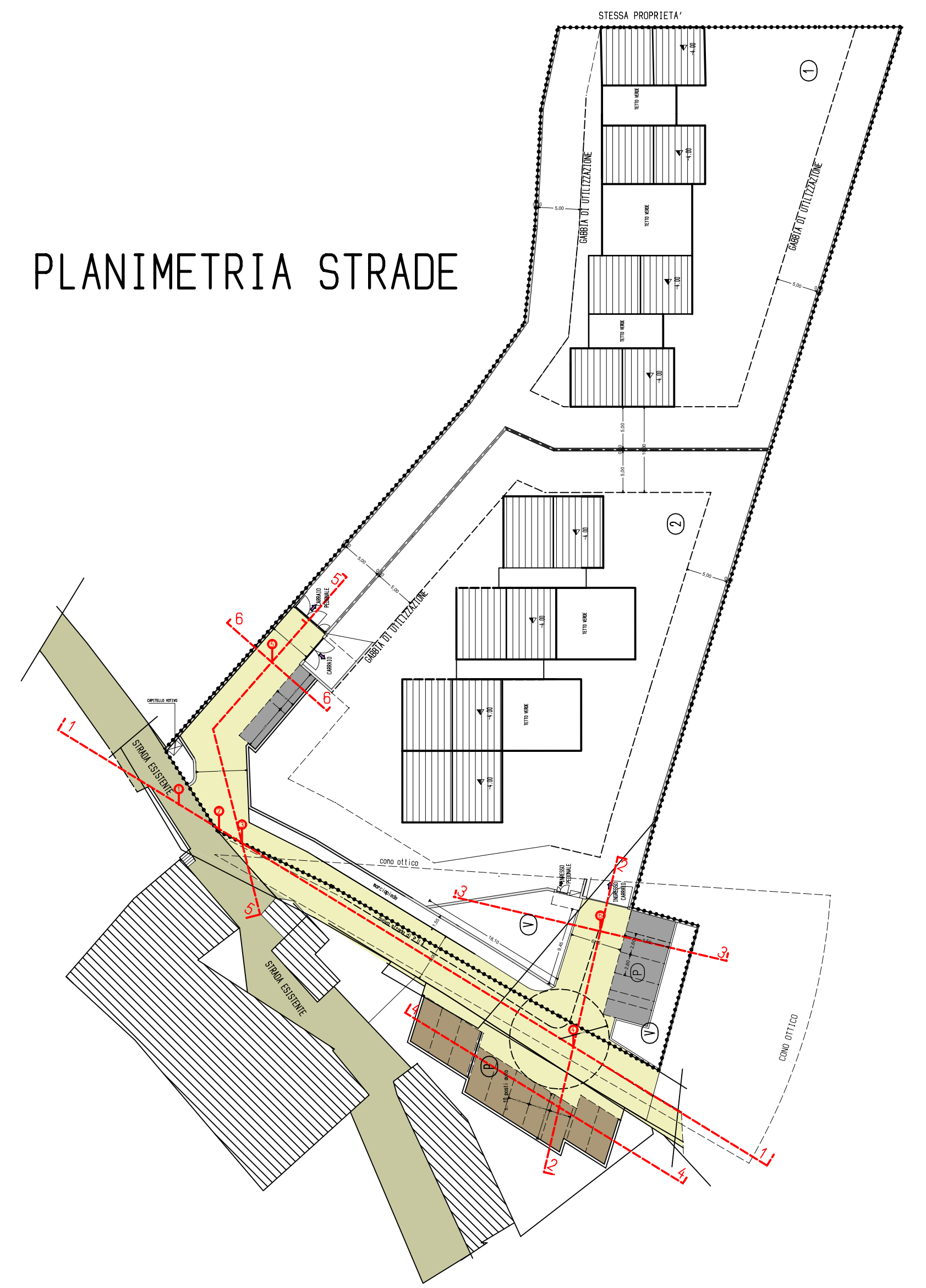

PROFILO 6-6 ATTUALE

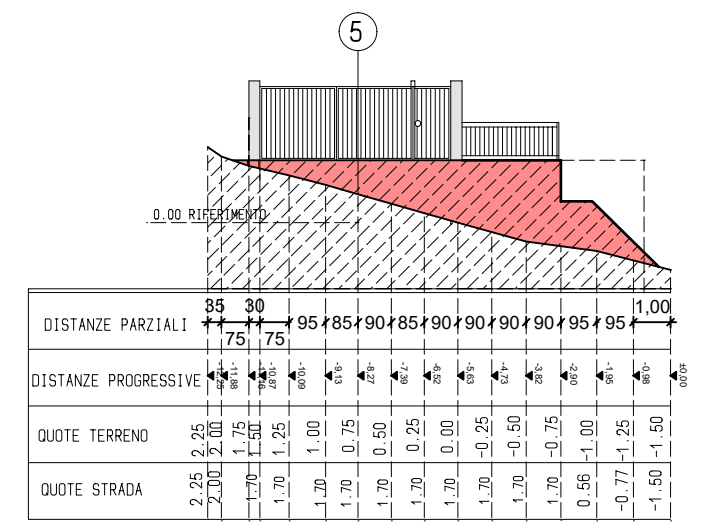

PROFILO 6-6 PROGETTO

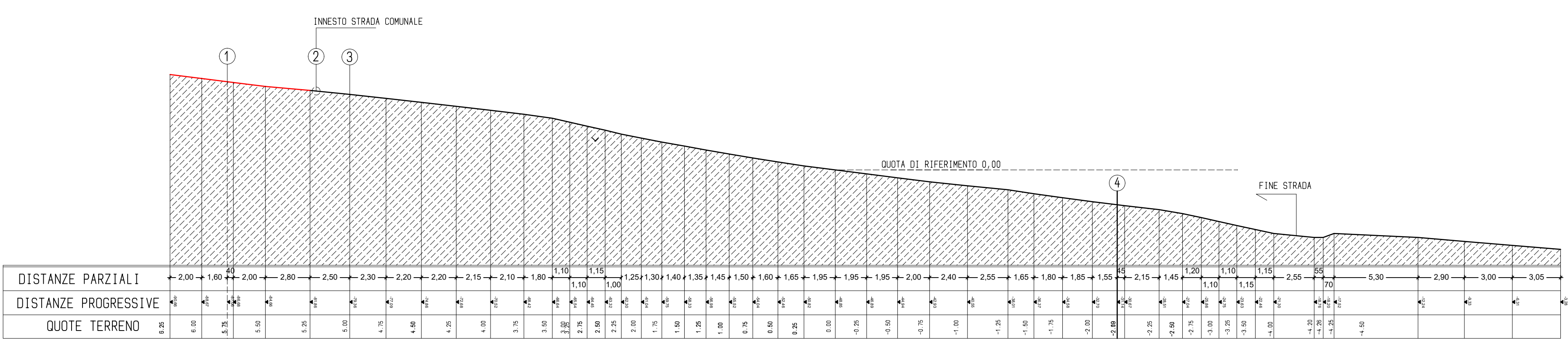

PROFILO 1-1 ATTUALE

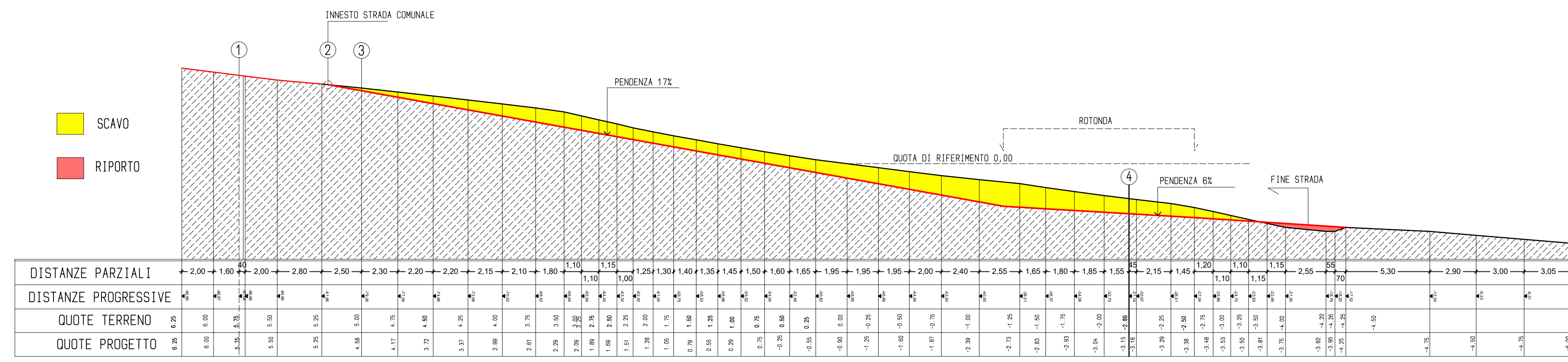

PROFILO 1-1 PROGETTO

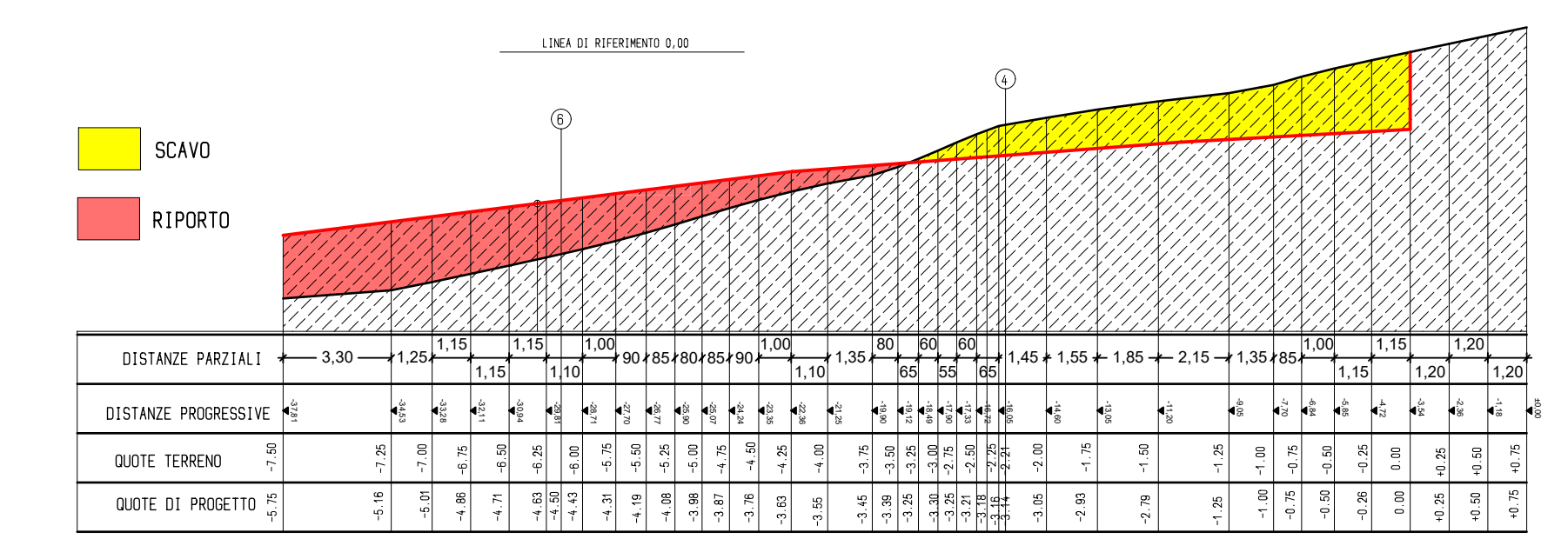

PROFILO 2-2 ATTUALE

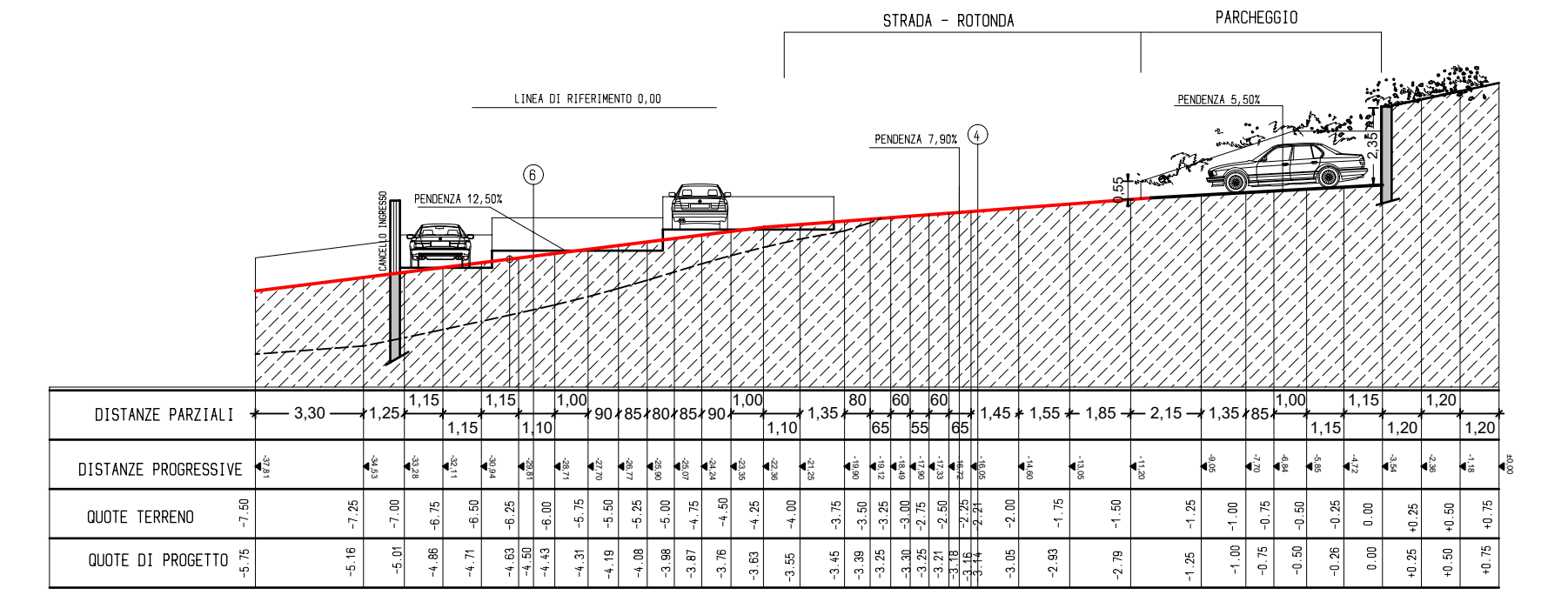

PROFILO 2-2 PROGETTO

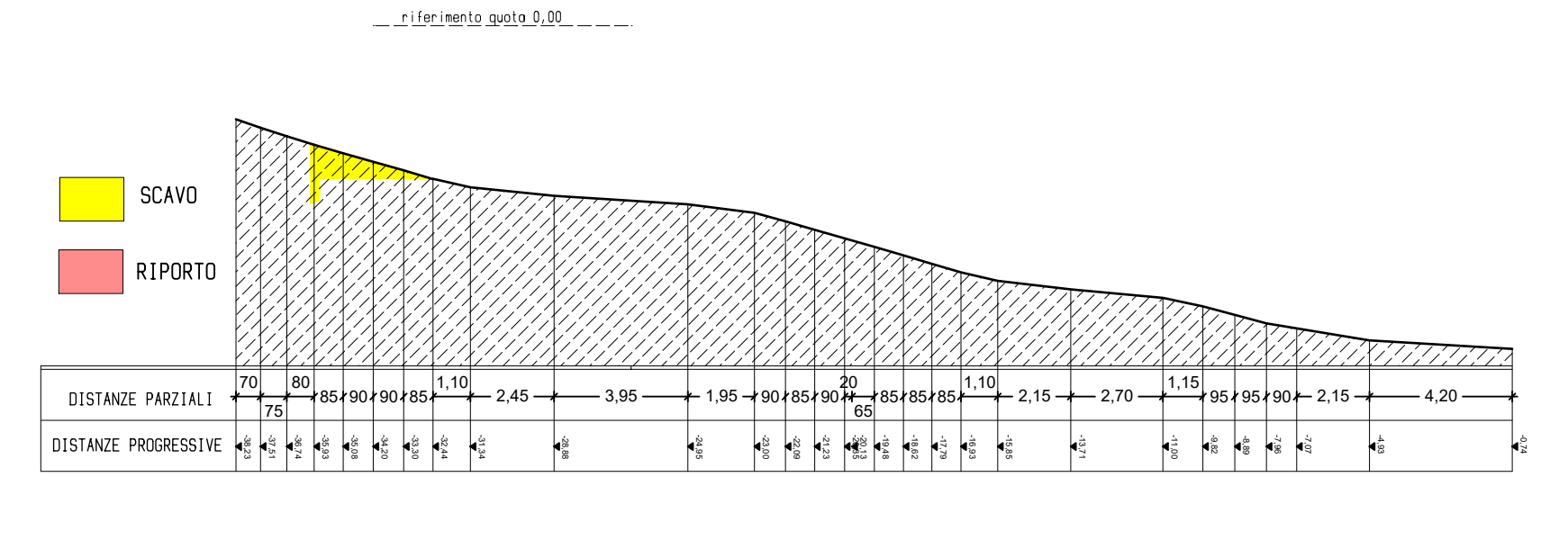

PROFILO 3-3 ATTUALE

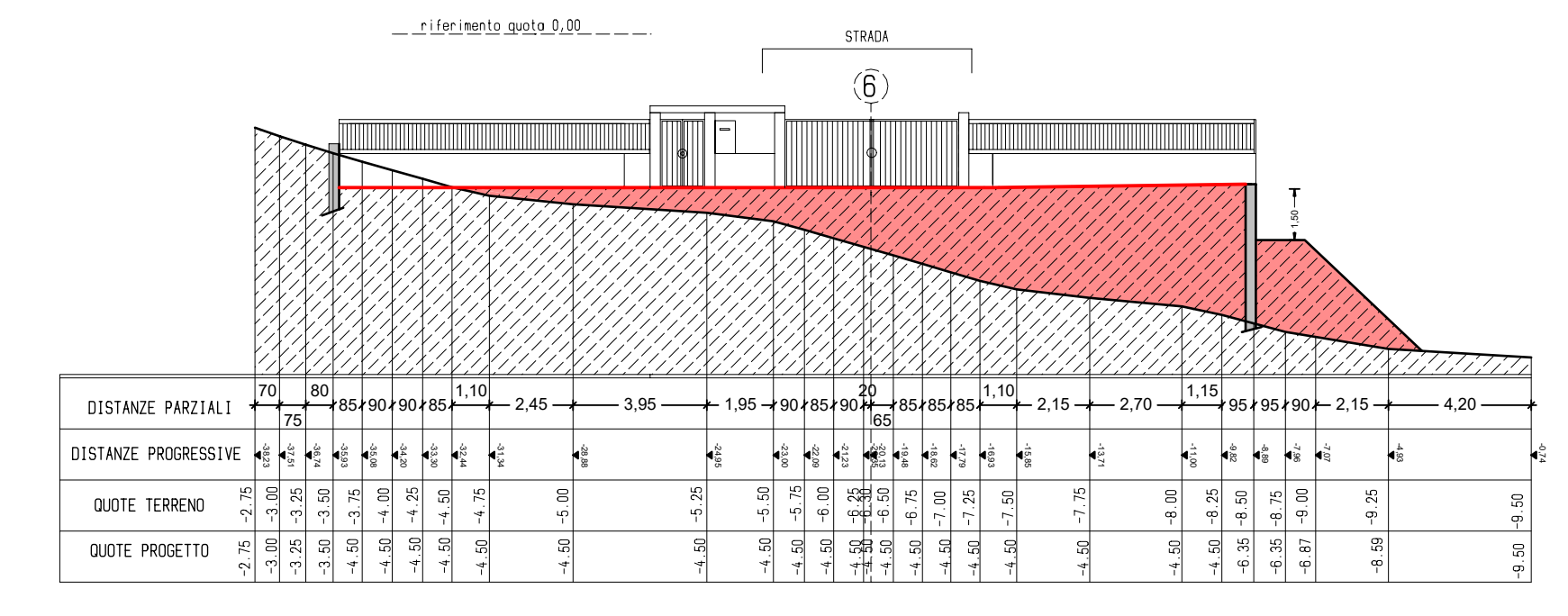

PROFILO 3-3 PROGETTO

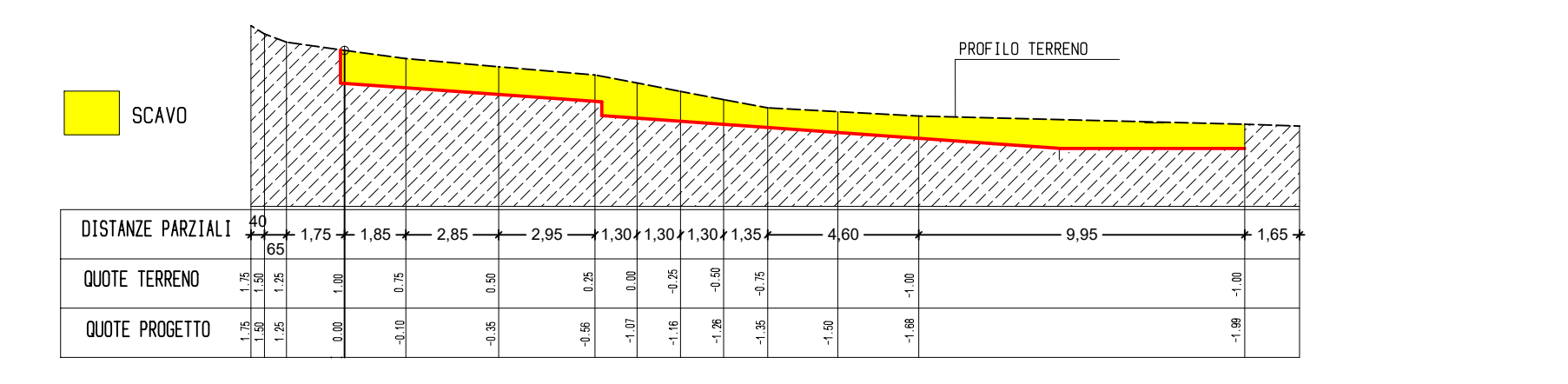

PROFILO 4-4 ATTUALE

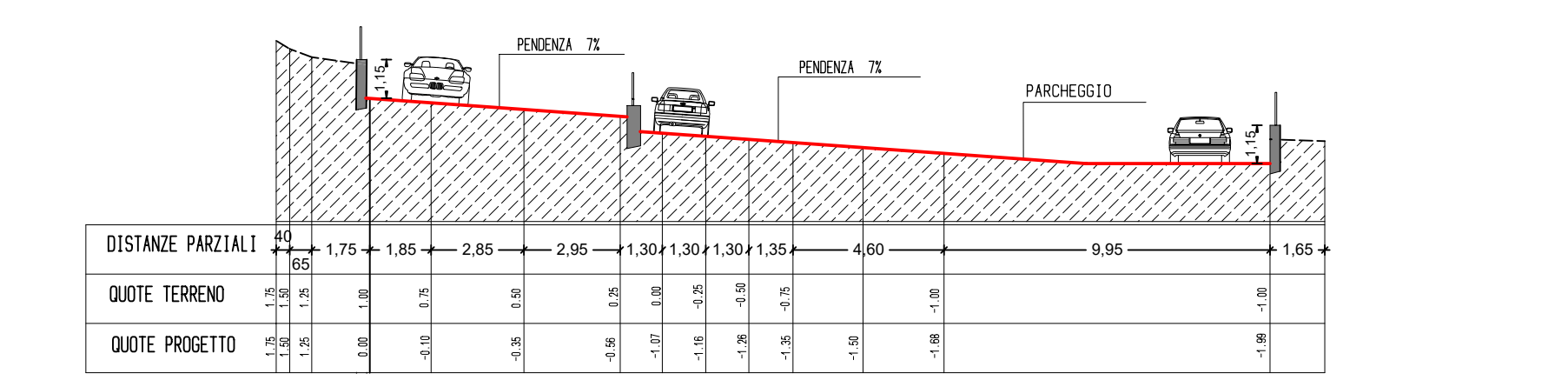

PROFILO 4-4 PROGETTO

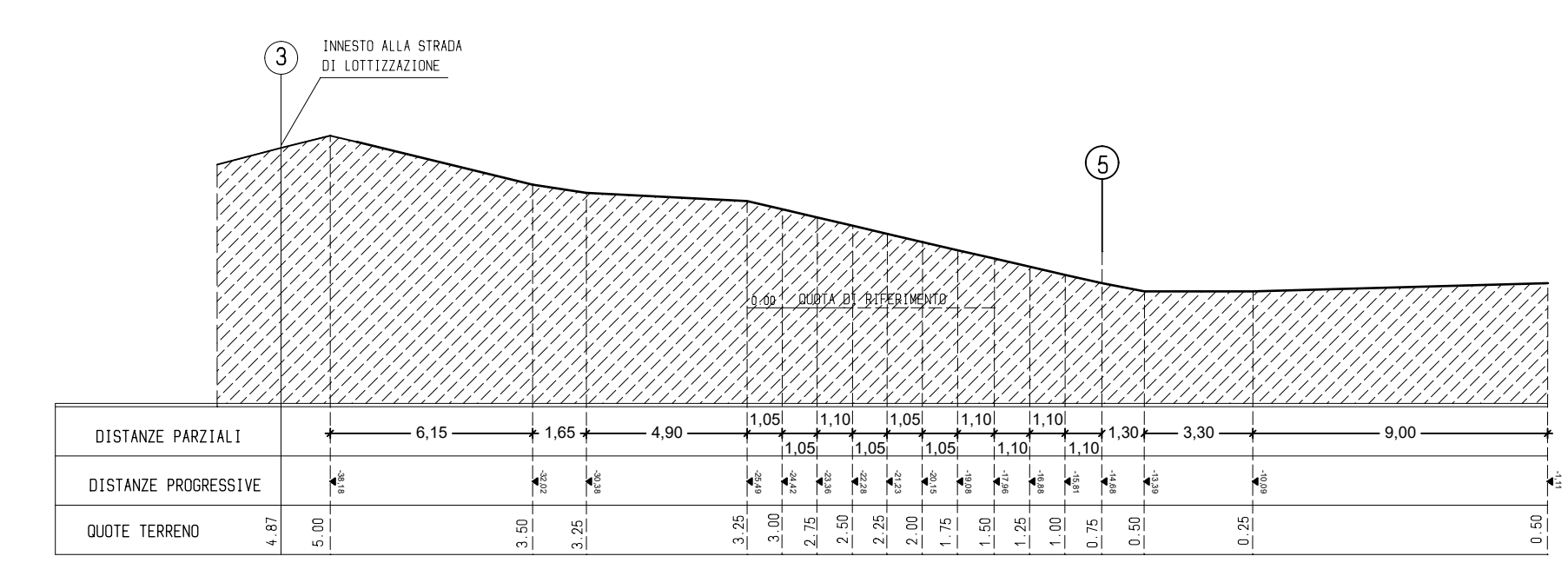

PROFILO 5-5 ATTUALE

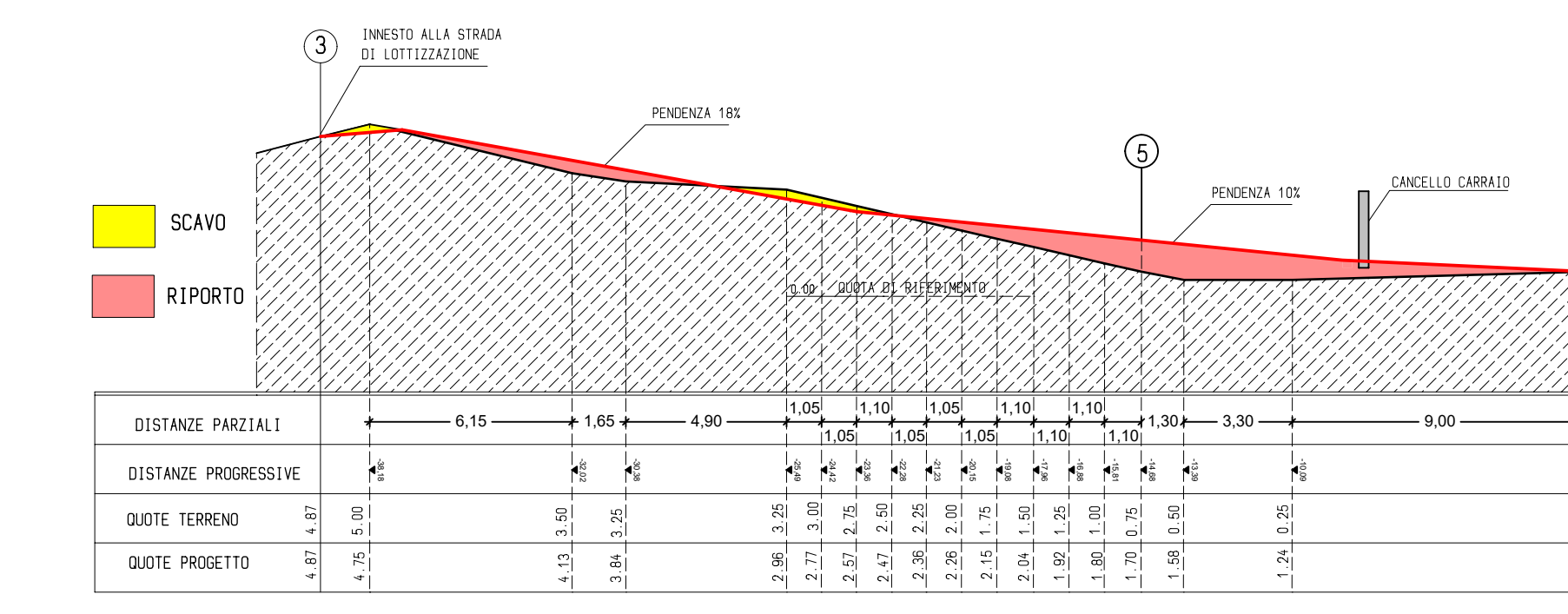

PROFILO 5-5 PROGETTO